

HOUSE & LAND PACKAGE



Lot 54
Kalimna Road
Nuriootpa

HOUSE & LAND
\$366,520*

georgia spa

Size Specifications

Living	229.73 m2
Verandah	7.3 m2
Carport	36 m2
Total	273.03 m2
Width	16.77 m
Depth	20.26 m

Inclusions

- Double Carport, 3 brick piers, 2 roller doors & concrete slab
- Carpet to bedrooms & living
- Tiles to the remainder
- Ducted reverse cycle air conditioning
- Stormwater disposal
- Perimeter paving (1m) and driveway
- Instantaneous hot water system
- Termite barrier to perimeter
- Upgraded tapware and china basins
- Colonial architraves and skirtings
- 1200mm high tiling (bathroom & ensuite) rows of tiles over kitchen
- Full width mirror over bathroom & ensuite
- Pivot shower cubicle doors
- Multi directional shower heads
- Built-in linen cupboard
- 1 3/4 bowl sink to kitchen
- Keylocks to sliding windows
- Exhaust fans
- Smoke detectors
- Choice of elevations

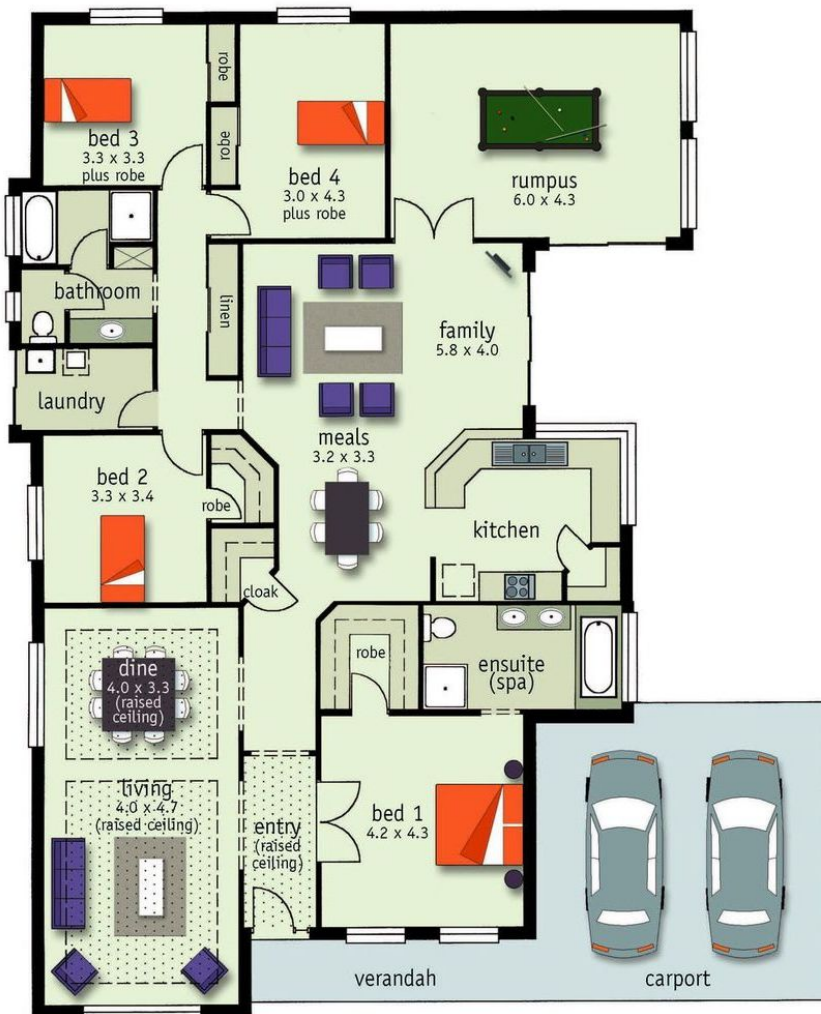

* Conditions apply. (c) The Hickinbotham Group 2010. Subject to conditions and acceptance by company. Not valid with any other offer. Price may change without notice. Valid for 7 days from 03/04/2010. The Hickinbotham Group - Unauthorised use of these plans constitutes a breach of copyright which will make you personally liable for damages. The industry standard is 20% of the contract sum. Lot 54 Kalimna Road Nuriootpa

For further details contact
Jason Vandermeent on 0418 602 701